

810

FIRE & LIFE SAFETY SITE CONDITIONS SUBMITTAL

Division of the State Architect (DSA) documents referenced within this publication are available on the DSA Forms or DSA Publications websites.

To facilitate the Division of the State Architect's (DSA) fire and life safety plan review of project site conditions, DSA requires the design professional to provide the following information at time of project submittal for projects consisting of construction of a new campus, construction of new building(s), addition to existing buildings, and for site alternate design means for fire department emergency vehicle access, and fire suppression water supply.

Information associated with compliance items 1 through 3 below is to be provided for all project types indicated above. Information associated with items 4 through 7 is to be completed when an alternate means is utilized. Acknowledgment by the school district and signature from the Local Fire Authority (LFA) is only required when an alternate design means is being requested.

The Project Information and Fire & Life Safety Information sections are to be completed for all projects and imaged onto the fire access site plan. When an alternate design/means is proposed, all sections on pages 1 and 2 are to be completed and imaged on the fire access site plan.

For additional information refer to the instructions at the end of this form and DSA Policy PL 09-01: Fire Flow for Buildings.

PROJECT INFORMATION

School District/Owner: Merced Community College District
 Project Name/School: Merced College
 Project Address: 3600 M Street, Merced, CA 95348

FIRE & LIFE SAFETY INFORMATION

1. Has a fire hydrant flow test been performed within the past 12 months? Yes Yes No
 (If yes, provide a copy of the test data.)

2. Was the fire hydrant water flow test performed as part of this LFA review? Yes Yes No

3. Is the project located within a designated fire hazard severity zone (FHSZ) as established by Cal-Fire? (If yes, indicate FHSZ classification below.)
 Yes No WIFA

Refer to the following website for FHSZ locations:
<http://oas.fire.ca.gov/FHSZ/>
 Moderate High Very High

Wildland Interface Area (WIFA) (If any designations are checked, project design must meet the requirements of CBC Chapter 7A.)
 WIFA

DSA 810
FIRE & LIFE SAFETY SITE CONDITIONS SUBMITTAL 4a note: Building width exceeds 150 feet from fire access road per CFC 503.1.1, approved by the LFA

CONDITION MEANS AND METHODS RESOLUTION	ALTERNATE ACCEPTED		
	Yes	No	N/A
4. Emergency vehicle access roadways do not meet CFC requirements.	X		
4a. Acceptable Alternate: Emergency vehicle and personnel access as proposed by the project architect is acceptable for providing fire suppression and protection of life and property.	X		
5. Fire Hydrants: Number and spacing does not meet CFC requirements.			X
5a. Acceptable Alternate: Number of fire hydrants and spacing as proposed by the project architect is acceptable for fire suppression and protection of life and property.			X
6. Fire Hydrants: Water flow and pressure are less than CFC minimum.			X
6a. Acceptable Alternate: The available flow and pressure is acceptable for providing fire suppression and protection of life and property.			X
7. Location of fire department connection(s) serving fire sprinkler systems or standpipe systems does not meet CFC requirements.			X
7a. Acceptable Alternate: The location of fire department connection serving the fire sprinkler system and/or standpipe system is acceptable for providing fire suppression and protection of life and property.			X

School District Acceptance of Acceptable Design Alternates

By signing this form, the school district acknowledges and accepts the proposed design as an alternative to California Building Code (CBC) and California Fire Code (CFC) minimum requirements, as indicated by one or more of the conditions indicated at items 4a, 5a, 6a or 7a, for providing fire and life safety protection of life and property.

Accepted by: Joe Allison Title: VP Administrative Services
 Signature: [Signature] Date: 10/29/2020

LOCAL FIRE AUTHORITY (LFA) INFORMATION

LFA Agency Name: Merced City Fire Department
 LFA Review Official: Casidy Wilson
 Title: Deputy Chief Work Phone: (209) 388-8035
 Work Email: wilsonc@cityofmerced.org

LFA Reviewer's Signature: [Signature] Date: 10/29/2020

DSA File No.: 24-C1
 DSA Application No.: 02-118421

IDENTIFICATION STAMP
 DIV. OF THE STATE ARCHITECT
 APP: 02-118421 INC.
 REVIEWED FOR: SS FLS ACS
 DATE: 11/17/2020

Agency Approval

SYMBOLS

- Assumed Property Line
- Accessible Path of Travel
- Fire Truck Access Lane
- PLUMBING, Fire Hydrant (FH)
- PLUMBING, Fire Department Connection (FDC) (Siamese)
- BUILDING OUTLINE
- Accessible Restroom Location:
 M = Men
 W = Women
 U = Unisex

ABBREVIATIONS

DF ACCESSIBLE DRINKING FOUNTAIN LOCATION
 (HA = High Adult)
 (LA = Low Adult)

NOTES

- Site Gates, Site Ramps, and Site Stair locations in the "Path of Travel" are indicated on Drawing REGULATORY COMPLIANCE SITE PLAN and FLOOR PLAN.
- The Path of Travel slopes shall not exceed a running slope of 1:20 (5%). The Path of Travel shall not have overhead obstructions within 8' above the walking surface or obstructions protruding more than 4" between 27" and 80" above the walking surface.
- The "Path of Travel" as shown on Drawing REGULATORY COMPLIANCE SITE PLAN, shall not have any unprotected vertical drop exceeding 4 inches at the time of the preparation of the contract documents and DSA approval. Contractor shall verify and bring any non-complying items to the attention of the Architect.
- All new concrete surface within the "Path of Travel" shall have a non-slip medium finish as called for in Specification Section CAST IN PLACE CONCRETE. A heavy finish shall be used on all slopes greater than 6%.

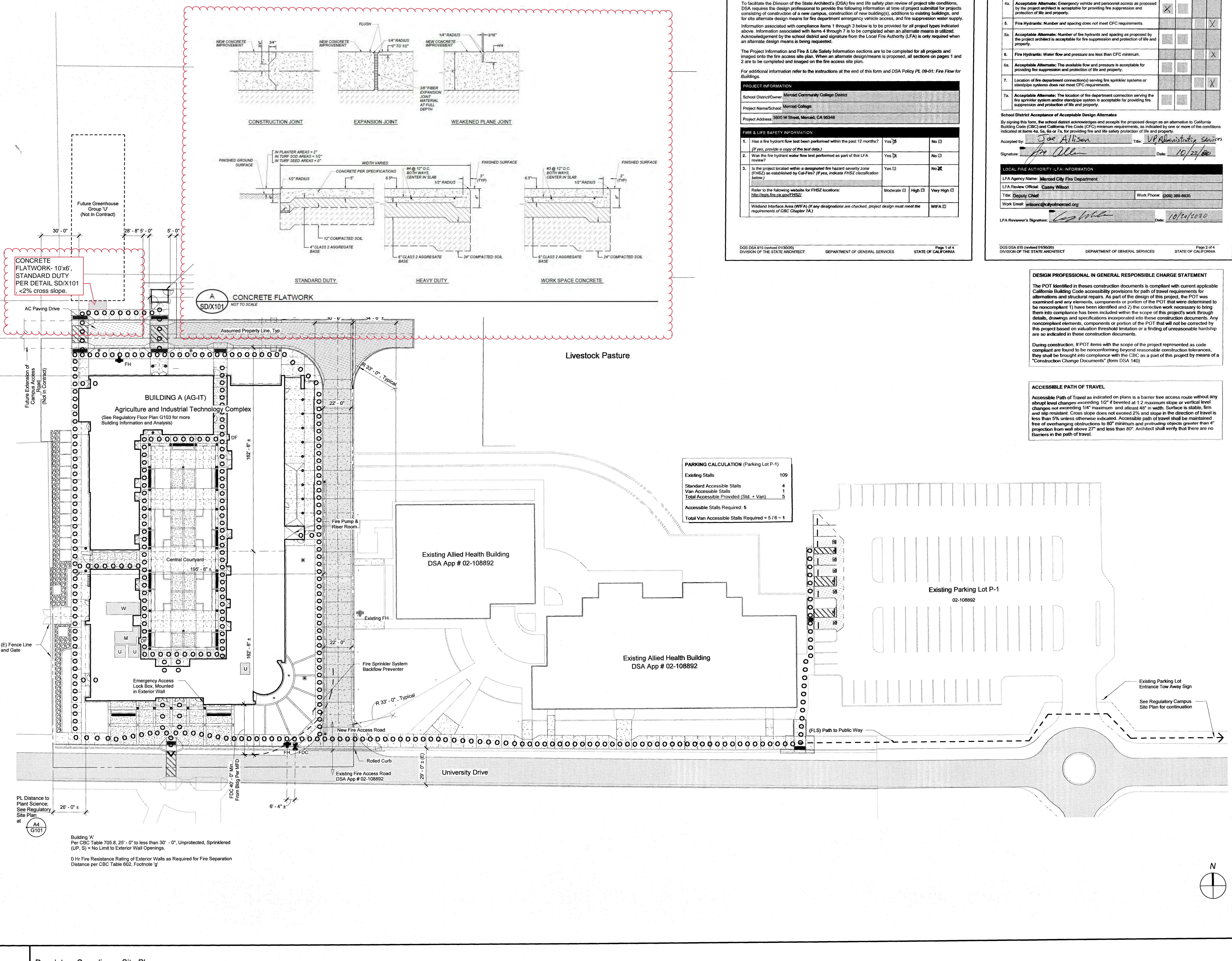

DESIGN PROFESSIONAL IN GENERAL RESPONSIBLE CHARGE STATEMENT

By signing this form, the school district acknowledges and accepts the proposed design as an alternative to California Building Code (CBC) and California Fire Code (CFC) minimum requirements, as indicated by one or more of the conditions indicated at items 4a, 5a, 6a or 7a, for providing fire and life safety protection of life and property.

The POT identified in these construction documents is compliant with current applicable California Building Code accessibility provisions for path of travel requirements for alterations and structural repairs. As part of the design of this project, the POT was examined and any elements, components or portion of the POT that were determined to be noncompliant 1) have been identified and 2) the corrective work necessary to bring them into compliance has been included within the scope of this project's work through details, drawings and specifications incorporated into these construction documents. Any noncompliant elements, components or portion of the POT that will not be corrected by this project based on valuation threshold limitation or a finding of unreasonable hardship are so indicated in these construction documents.

During construction, if POT items with the scope of the project represented as code compliant are found to be non-complying beyond reasonable construction tolerances, they shall be brought into compliance with the CBC as a part of this project by means of a "Construction Change Documents" (form DSA 140).

ACCESSIBLE PATH OF TRAVEL

Accessible Path of Travel as indicated on plans is a barrier free access route without any abrupt level changes exceeding 1/2" if beveled at 1:2 maximum slope or vertical level changes not exceeding 1/4" maximum and allowed 48" in width. Surface is stable, firm and slip resistant. Cross slope does not exceed 2% and slope in the direction of travel is less than 5% unless otherwise indicated. Accessible path of travel shall be maintained free of overhanging obstructions to 80" minimum and protruding objects greater than 4" projection from wall above 27" and less than 80". Architect shall verify that there are no barriers in the path of travel.

H18 Regulatory Compliance Site Plan Legend

General Notes

Consultant

Ag Science & Industrial Tech Complex
 Merced College
 3600 M St. Merced, CA 95348
 Project

Site Development
 REGULATORY SITE PLAN
 Drawing

ARCHITECTURE
 PLANNING
 INTERIORS
 www.dardenarchitects.com
 6790 N. West Ave. • Fresno, CA 93711 • T. 559.448.8051
 Architect

No.	Revision/Submission	Date

Revision

Designed By: _____ Copyright 2020 Darden Architects
 Drawn By: _____

Scale: As indicated Project Number: 1951 Date: 10/14/2020
 Checked By: _____ Reviewed By: _____

G102

Sheet _____ of _____

10/14/2020 2:55:38 PM C:\Users\willamb\Desktop\Project Shortcuts\1951_Merced College_AGIT_Site-NEW\H18_willamb.rvt

A1 1" = 30'-0"

Regulatory Compliance Site Plan