

## 2022-10 PLANT SCIENCE YARD PROJECT

### ADDENDUM #1

The following RELOCATED structures to be moved as part of the Scope of Work by the Contractor:

- 1) (2) Loafing Sheds
- 2) (2) Shipping Containers
- 3) Relocated Greenhouse 1 and Relocated Greenhouse 2



Shipping Containers (2)



Loafing Sheds (2)



Greenhouse 1



Greenhouse 2

#### Greenhouses 1 and 2:

- Contractor to replace wood mounting rails and skirt boards.
- Contractor to replace all corrugated plastic on end panels.
- Replace wood, corrugated plastic and wiggle wire
- Contractor to relocate all galvanized expanded metal bench tables located in Greenhouse 1 & 2.

Potting Shade Structure: 50' x 50' Potting Shade Structure to be CONTRACTOR furnished and CONTRACTOR installed (Sheet- PS).

#### Existing Fence Demo:

- Existing metal t-post barbed wire fence on West and South border of Project site will be demolished and hauled away by the Contractor.

SHADE STRUCTURE: Shade structure to be provided by Owner and installed by Contractor.

**SHADE STRUCTURE DETAILS:**



**Primary Structure: W-Truss Frame**

<b>Dimensions:</b> 60' W x 80' L	<b>Anchoring:</b> Hilti expansion anchor bolts 1/2" x 4.5" bolts
<b>Square Footage:</b> 4800	<b>Vertical posts:</b> 3" x 3" x 13' - 12 GA galvanized steel with base plate
<b>Post Height:</b> 13'	<b>Truss:</b> 2" x 2" square top and bottom chords, galvanized webbing
	<b>Covering:</b> Aluminet 40% in 20' x 20' blocks

**W- Truss Frame Package will include the following:** **Included**

3" x 3" x 13' x 12 ga. vertical posts with 7" x 7" x 1/2" base plates in 20' x 20' blocks, expansion anchor bolts, 20' galvanized truss members, hardware, and assembly instructions.

**Covering** **Included**

40% Aluminet Shade Cloth  
 3 each: 28'W x 80'L = 6720sqft  
 \*\*\*CUT TO\*\*\* 12 each: 20' x 20' blocks (Include Drops)  
 Taping all around.  
 Grommets on all corners and spaced 18" o/c  
 10 " Bungee ball cords

**SHADE STRUCTURE TYPICAL FOOTING DETAIL**

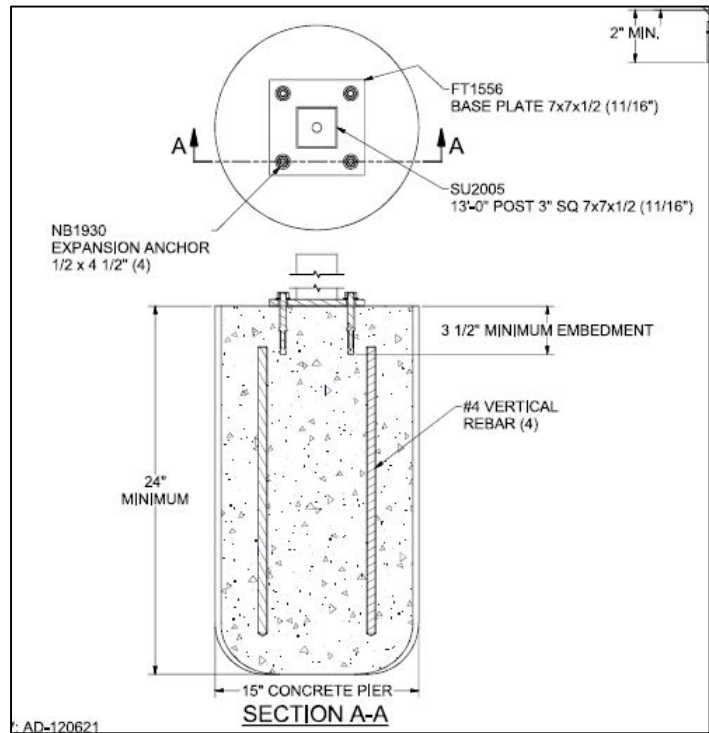

SHADE STRUCTURE BASE  
PLATE DETAIL

